



MRAMORIT

## TECHNICAL DATASHEET

### MATERIAL – CAST MARBLE

The base ingredient in the production of cast marble is **limestone**. Other materials serve as binder or constitute part of the surface layer. Depending on customer's requirements, special fillers that create structures and colours of marble, granite, onyx, or the so called UNI-colours, i.e., unicolour surface.

### VARIANT – WASHBASINS WITH SELECTABLE DIMENSIONS AND SHAPE

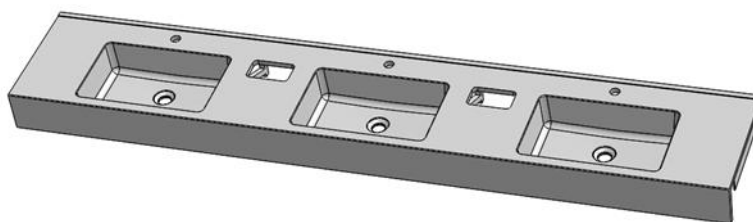

The **VARIANT variable system** allows to create custom single piece wastops with integrated washbasins **with the length of up to 3,900 mm**. In case of washbasins longer than 3900 mm, it is possible to create invisible joints at the assembly site. Wash spots can be placed almost anywhere in the wastop. We offer a large number of shapes. Examples of basic shapes:



**Overflow** is addressed using a drilled overflow or by using the GEBERIT CLOU waste system. It is also possible to use a constant flow valve.

Should the **rear face** of the wastop be a single piece together with the wastop, the depth of the washbasin cannot be **bigger than 630 mm**. The height of the rear face in such cases is **selectable** – 30 mm, 50 mm, 80 mm, and 100 mm. We also offer the size of 3 mm and 10 mm.

If the wastop is equipped with a **front face**, the front face is glued on and is manufactured in heights **from 60 to 190 mm**, depending on the depth of the wash spot.. The front face of the wastop can be **ended by a right-angle side ending, inner or outer bevelling, or arch ending**. The glued joint is invisible.



MRAMORIT

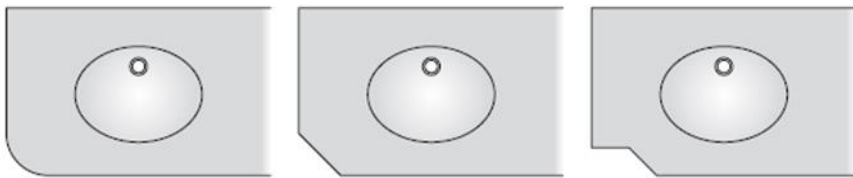

The standard variant is produced **with a hole for a pillar mixer**. Washtops with dimensions other than those listed in the datasheets need to be consulted with the manufacturer from the technical standpoint.

**The minimum spacing between washbasins according to the standard is 700 mm.** Smaller spacings also possible at customer's request.

It is also possible to add **soap dispenser holes, holes to throw paper towel into, towel hanging holes** in the face or build a **paper towel dispensers** into the front face.



### INSTALLATION OF ATYPICAL SLAB WASHBASINS

The building has to be finished construction-wise and **the washbasin installation should be one of the last steps** (the washbasins can be damaged by other crafts).

**Spirit-leveled brackets** are installed and the slab washbasin is laid on this flat surface. The washbasin cannot be removed from the original packaging until it is placed on the brackets. The washbasin can be damaged if placed improperly.

In Káranice

08/02/2019